

Standing Seam Swivel for metal roofs

Tested on standing seam roofs as a temporary fall arrest anchor for one person using a retractable lifeline. Makes safe work on HVAC units, gutters, siding and maintenance work on metal roofs. Clamps bolt on to standing seam of roof. Does not pierce or penetrate roof so guarantees are not violated.

- Reusable temporary anchor for metal roofs
- Pinch mounts to standing seams
- Provides an anchor on roof without piercing through metal
- Designed for retractable lifelines up to 50ft
- Legs adjust 24" through 36" to fit standing seam spacing
- Allows 360° rotation of retractable
- Keeps retractable vertical for optimal performance



SRL 35ft Cable

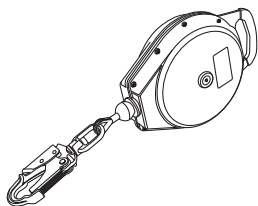

CR-230

Standing Seam Swivel

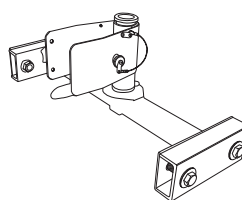

AC-250