

Beam Trolley

Convert an overhead I-beam into a mobile fall arrest anchorage point. Rated to 5,000lbs it provides fall arrest protection for one person and moves smoothly along an I-beam on heavy duty wheels.

- Rolls along I-beam as an overhead mobile fall arrest anchor point
- Works well with self retracting lanyard
- Keeps anchor point over place of work avoiding swing falls
- SA-015 Adjusts to fit flange widths up to 4 1/2"
- SA-019 Adjusts to fit flange widths up to 8 3/4"

D-ring Anchor Plate

Stainless steel anchor plate with D-ring attachment point. Bolt or weld to structure. Plate size 2" x 4 1/4". Has two 1/2" holes. 5,000 lbs rating.

D-Anchor

Forged anchorage connector, shaped to avoid pressure on gate of snap hook. Mounting surface must have minimum tensile strength of 5,000 lbs. If mounted on a vertical surface such as a wall, the ring must be perpendicular, at right angles to the ground. 5,000 lb 22.3 kN strength.

- 1/2" hole (65-75 ft lb)
- With bolt incorporated (45-55 ft lb torque value)

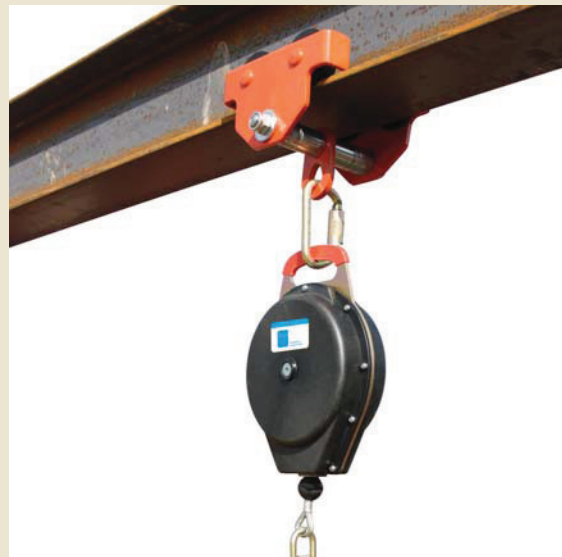

Beam Trolley

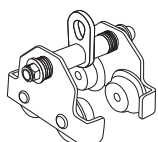

SA-015, SA-019

D-Ring Anchor Plate

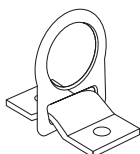

AC-360

D-Anchor



AC-370